

LIFT CONCEPTS - PL

IMPORTANT

MECHANISMS WHICH LIFT OR MOVE WEIGHTS NEED TO BE CHECKED ON A YEARLY BASIS FOR ANY DAMAGE WHICH MAY RESULT IN AN ACCIDENT.

FUNCTION

The PL (Plasma Lift) range of lifts are mechanisms which will open an electric flap on top of a cabinet before lifting a plasma/LCD TV into view.

The range is custom size to suit the screen and has a number of options.

SUITABILITY

Flat screens from 26" to 50" fit in this range. There are six widths six heights and three depths.

PL - Straight Lift
PLI - Inverted for Ceiling Use
PLS - For up and Swivel
PLH - For up and Hinge Out.
ALL HAVE THE FLAP MECHANISM

SPECIFYING

- Decide on the action. Straight lift, swivel etc.
- Decide on screen.
- Check Cabinet Dimension Sheet to see the size of the cabinet based on the chosen screen.
- Cabinet can be made while the lift is being built.

CONTROL

Supplied with basic infrared remote control. Can be learnt by many learning remotes.

Also has switch control so can be operated by relays, switches, Crestron/AMX or Lutron systems.

www.futureautomation.co.uk

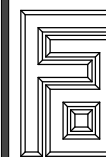

**LIFT
CONCEPTS**
PL FL AND SL

20/05/2005

Sheet 1 of 3

MECHANISED
FLAP POPS UP
TO FILL OPENING

DOWN

UP

CUSTOM MADE
CABINET BY
OTHERS MANY
STYLES POSSIBLE

PLASMA LIFTS
INTO VIEW

FLAP DOWN

PLASMA DOWN
IN CABINET

PLASMA UP
WITH FLAP
INSIDE CABINET

UP

A

A

BASE WOOD TO
FILL THE OPENING
IN THE UP POSITION

FLAP

SECTION
BB

SECTION
AA

WARNING

IT IS THE RESPONSIBILITY OF THE INSTALLER TO WARN ALL POTENTIAL END USERS OF THE DANGERS OF INTERFERING WITH MECHANISMS DURING OPERATION

PLS Plasma Lift Swivel

VIEW FROM ABOVE

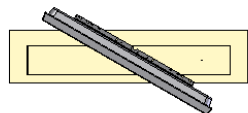

VIEW FROM ABOVE

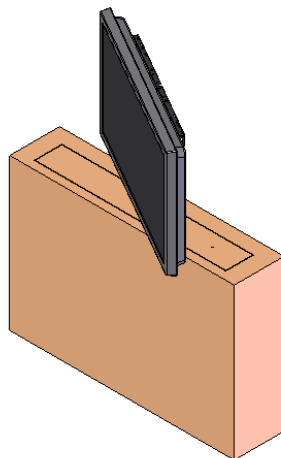
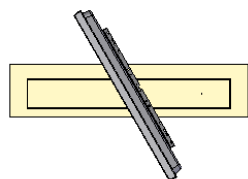

PLS - The electric flap opens as per the standard lift and the plasma rises. At the top it pivots around its centre as shown in the plan above.

Suitable for 26" to 50" plasmas swivelling in one direction only. Up to 180 degrees of movement. Angle is set up on installation. Can be instructed to lift and not swivel.

See Standard PL Cabinet Dimensions for details of sizes. (The swivel unit just adds an extra 100mm to the height of the standard lift).

FL and FLS Flat Screen Lift

The FL range is simply for smaller screens. The straight FL lift with mechanised flap is suitable for LCD screens from 10" to 22".

A swivel version is available, the FLS, with the same spec as the PLS.

See FL Cabinet Dimensions for details.

PLI Plasma Lift Inverted

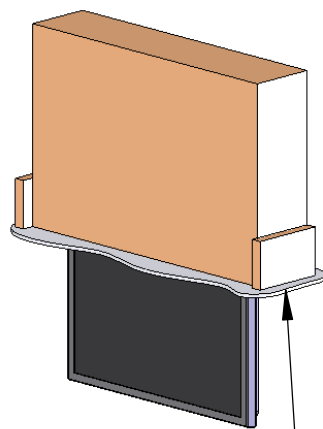

Plasterboard

PLI - The electric flap opens as per the standard lift but it is lifted up in to the ceiling. The plasma screen then lowers from the ceiling.

Suitable for 26" to 50" plasmas. Only a basic enclosure is required in the loft/ceiling void. The screen will drop so it is just below the ceiling.

See PLI Cabinet Dimensions for details of sizes. A swivel option can be added as per the PLS.

General Notes on Screen Mounting

The smaller FL range (left) supports the standard VESA 100 mount system used on most small LCD screens.

The PL, PLS, PLI, PLH all have our universal Group 'A' or Group 'C' frames fitted as standard. Try and stick to screens in these lists.

Whether you use a standard screen or require a custom mounting, all bolts will be supplied to attach the screen to the mechanism.

PLH Plasma Lift Hinge

VIEW FROM ABOVE

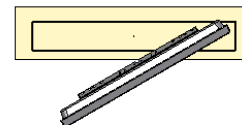

VIEW FROM ABOVE

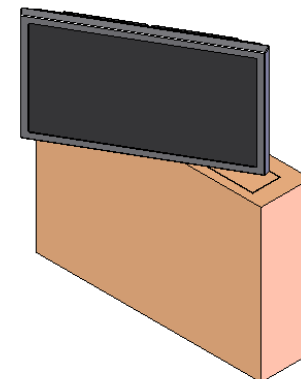
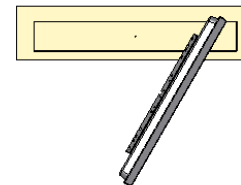

PLH - The electric flap opens as per the standard lift and the plasma rises. At the top it pivots from one edge as shown in the plan above.

Suitable for 26" to 50" plasmas hinging out in one direction only. Up to 90 degrees of movement. Angle is set up on installation. Can be instructed to lift and not hinge out from the remote.

See PLH Cabinet Dimensions for details of sizes.

PLR

The Plasma Lift Rack offers solutions for larger screens 55" to 65".

www.futureautomation.co.uk

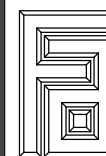

**LIFT
CONCEPTS**

20/05/2005

Sheet 2 of 3

SL - SHELF LIFT

Shelf on top of the screen can be kept to the minimum width and thickness

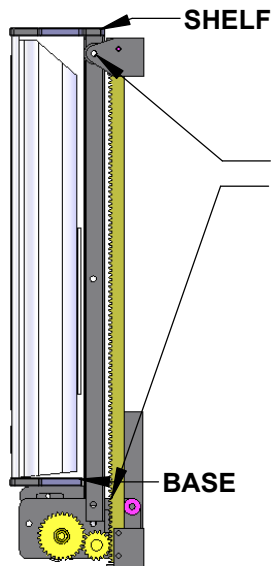
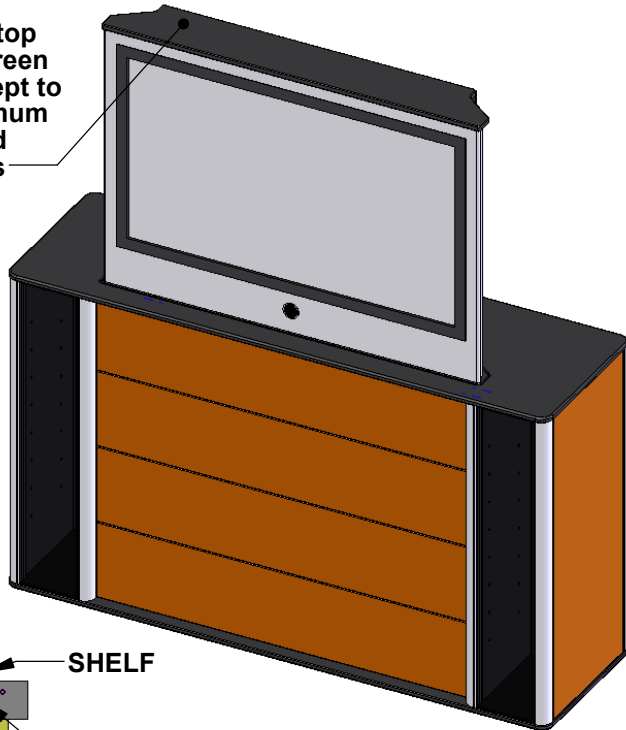

In the down position the screen is supported here and - here making this ideal for marine applications.

MARINE SUITABLE

Shelf drops into the cabinet opening with a constant shadow gap

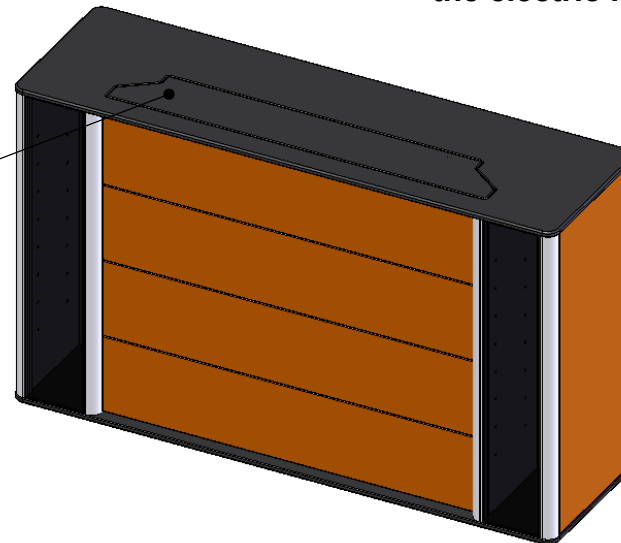

NEW PRODUCT

The Future Automation range of lifts, described on the previous pages, covers many options and allows efficient use of cabinet space.

This is achieved using a modular format of many different width, height and depth options.

The mechanised flap offers the ultimate concept in making the cabinet look good in both the up and down positions.

Our new Shelf Lift offers a lower cost option while solving many of the problems associated with simpler lifts.

Flat screen lift mechanisms have traditionally used large shelves on the top of the screen or a cumbersome wooden box surround to solve the problem of filling the cabinet top in the down position.

These methods look crude and have various alignment problems. This new Shelf Lift solves these problems by guiding the back of the screen at the top. It enables the 'shelf' to drop down into the cabinet top with a constant shadow gap around its perimeter.

It won't achieve the visual or practical effect of the electric flap, but it does offer a lower cost lift which solves many of the practical problems associated with lift mechanisms.

www.futureautomation.co.uk

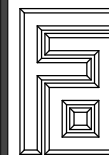

SL
SHELF LIFT

20/05/2005

Sheet 3 of 3